



DIAMOND PRESS RELEASE

DIAMOND presents the Expanded Beam (XB) lensed ferrule connector series

Switzerland, Losone, October 2019. DIAMOND SA, the leader in high precision fiber optic interconnect solutions, is pleased to introduce the Expanded Beam (XB) lensed ferrule series. As the newest addition to the company's well-established fiber optic product range, the new XB series offers revolutionary lensed ferrule technology, ensuring reliable and maintenance-free optical connections with insensitivity to dirt and debris.

The growing deployment of optical fiber in industrial, avionic, military and transportation applications are leading to the increasing use of optical connectors providing low insertion loss, ease-of-use and, more important, serviceability. Connector contaminants are the leading cause of power loss and signal degradation, often requiring the continuous need for cleaning, which can be considered a drawback for the replacement of copper wiring. As a result, there is a requirement for reliable and maintenance-free optical connectors insensitive to dirt and debris, especially in harsh environments. For this reason, a novel modular, single-mode lensed ferrule has been developed by DIAMOND. Its compact form-factor design fits into standard connector bodies (i.e. E-2000™, MPO, MIL-38999, etc.), offering insensitivity to contamination and mating-cycle reliability, typically found in bulky harsh environment lensed connectors.

The alignment accuracy between a fiber and a lens must be under 1 μm in order to attain acceptable insertion losses, which is normally difficult to obtain. To achieve this level of accuracy, DIAMOND uses exceedingly precise components and unique assembly techniques, keeping ultra-low mechanical tolerances in the processing of ceramics and opto-mechanical components. The result is a highly repeatable, low insertion loss ferrule, that opens new perspectives in the context of optical connections, where mating-cycles, dust insensitivity, reliability and low losses are required.

The new XB series will be presented at Photonics West 2020 exhibition in San Francisco. Photonics West 2020, February 04 – 06, 2020 – North Hall booth #2248



Expanded beam (XB) ferrule

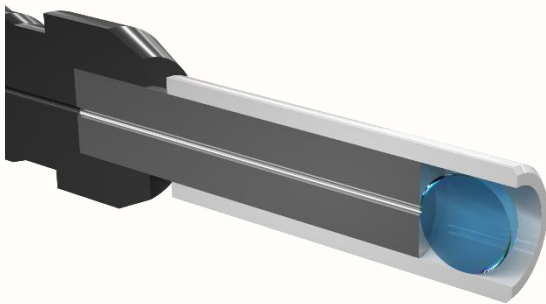

Cross-section of the XB lensed ferrule

About DIAMOND SA

DIAMOND SA is recognized worldwide for providing the highest quality and technically advanced fiber optic interconnect products and solutions. We employ state-of-the-art production methods and techniques that are unparalleled in the market. Our patented two-part ferrule, combined with the precision of our “Active Core Alignment” process, results in superior optical performance. Other products and technologies include Power Solution, Polarization Maintaining, Expanded Beam and High Temperature.

www.diamond-fo.com

Media contact

Malin Sparano
Head of Marketing
malin.sparano@diamond-fo.com
+41 58 307 45 45

Christoph Werner
Head of Product Management
christoph.werner@diamond-fo.com
+41 58 307 45 45